

g = inlet distance from ground:   
h = outlet distance from ground:

Item	Part	Description	Std. qty.	Need
1	Pumping station housing	fiberglass, $\varnothing 600$	1	
2	Inlet sewer	De110 PVC	1	
3	Flow sedative	fiberglass	1	
4	Submersible pump		1	
5	Pump base	cast iron, quick-lock	1	
6	Pressure piping	DN50 PE	1	
7	Non-return valve	DN50 PN10	1	
8	Cone fitting	DN50 PN10	1	
9	Ball valve	DN50 PN10	1	
10	Outlet sewer	DN50 PE	1	
11	Ventilation outlet	De110 PVC	1	
12	Cable gland	DN50	1	
13	Insulation cover	polystyrene	1	
14	Float switch	PP	2	
15	Control module	with level alarm	1	
16	Lifting hook	AISI 304	2	
17	Maintenance cover	plastic	1	
18	Lifting chain	AISI 316	1	

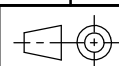

Weight

Date

19.05.2021

Drawn by E. Väljaots

Drawing no. KPP.06.01



**Klaasplast OÜ**  
reg.kood: 11862070  
tel: +372 5691 1914  
info@mahuti.ee  
www.mahuti.ee

Title

Pumping station

Sheet  
1/1

Scale  
1 : 15

Article no.